



Rugged, Reliable, Mobile, Secure™

DataPort 4-Bay Mini SAS Enclosure



Package Contents

- 1 – DataPort 4-Bay Mini Enclosure
- 4 – Screw kits
- 1 – Power Cable

The DataPort 4 Bay Mini Enclosure supports up to 4 SATA or SAS hard drives. The DataPort Enclosure requires a multi-lane cable with the SFF-8470 connector.

NOTE: The DataPort Enclosure does not include the required external enclosure to host cable.

The DataPort Enclosure supports two different multi-lane cables, the SFF-8470 (InfiniBand) to SFF-8470 (InfiniBand) cable (CRU PN 7366-700-03) or the SFF-8470 (InfiniBand) to SFF-8088 (Mini-SAS) cable (CRU PN 7366-701-01). Consult your host bus adapter manual to determine which interface it supports.

For internal host support CRU provides a cable assembly kit. The 4x SATA to SFF-8470 (InfiniBand) PCI host adapter with (4) SATA data cables and SFF-8470 (InfiniBand) to SFF-8470 (InfiniBand) external cable (CRU part number 7100-800-10) will provide the end to end cabling required to set up the DataPort Enclosure.

These cables are available through CRU's authorized resellers or direct from CRU at www.CRU-DataPort.com.

Hard Drive Installation

1. Remove the screws holding the cover on the DataPort 4-bay Mini Enclosure. Slide the cover off the enclosure.
2. Remove the front bezels.
3. Connect the SAS/SATA cable to the hard drives. Slide the hard drive into the enclosure and secure the hard drive with the provided screws.

NOTE: As the hard drives slide into the enclosure carefully fold the cables to avoid damaging the hard drive connectors.

4. Slide the cover on the enclosure and secure it with the cover screws.

Enclosure Setup Instructions

1. Power off the host computer.
2. Connect the host computer to the DataPort Enclosure with an external multi-lane cable (not provided).
3. Install hard drives.
4. Power on the DataPort Enclosure with the power button located on the back of the enclosure (see Figure 2). For best results power on the enclosure prior to powering on the host system.

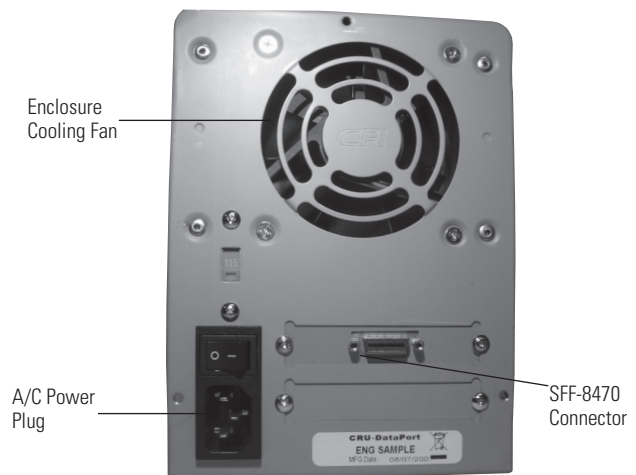

Figure 2: Enclosure Rear View



Rugged, Reliable, Mobile, Secure™

Product Warranty

CRU-DataPort (CRU) warrants the DataPort 4 Bay Mini Enclosures to be free of significant defects in material and workmanship for a period of one year from the original date of purchase. CRU's warranty is nontransferable and is limited to the original purchaser.

Limitation of Liability

The warranties set forth in this agreement replace all other warranties. CRU expressly disclaims all other warranties, including but not limited to, the implied warranties of merchantability and fitness for a particular purpose and non-infringement of third-party rights with respect to the documentation and hardware. No CRU dealer, agent or employee is authorized to make any modification, extension, or addition to this warranty. In no event will CRU or its suppliers be liable for any costs of procurement of substitute products or services, lost profits, loss of information or data, computer malfunction, or any other special, indirect, consequential, or incidental damages arising in any way out of the sale of, use of, or inability to use any CRU product or service, even if CRU has been advised of the possibility of such damages. In no case shall CRU's liability exceed the actual money paid for the products at issue. CRU reserves the right to make modifications and additions to this product without notice or taking on additional liability.

FCC Certification

This device has been tested and found to comply with the limits for a Class B digital device, pursuant to Part 15 of the FCC rules.

Operation is subject to the following two conditions:

1. This device may not cause harmful interference, and
2. This device must accept any interference received; including interference that may cause undesired operation.

IT Power Systems

This enclosure is intended for use on a TN power system. This enclosure was evaluated for use on an IT power system in accordance with Norway National Differences to IEC60950-1.

Register your product at www.CRU-DataPort.com.

A5-000-0004 Rev 2.0